

# MINIMUM PRESSURE VALVE



## MAIN FEATURES:

Usually installed on the discharge port of the separator tank, minimum pressure valves are available in a threaded or flanged version. They include a poppet to maintain minimum pressure in the separator tank when the compressor is started and a check valve to prevent air backflow from the line. The **Minimum pressure valve series is also available for Natural Gas and Water Lubricated applications.**

## MAINTENANCE:

The wear-and-tear of valve components depends on compressor applications and operating parameters. Valve inspection and ordinary maintenance are recommended using VMC's original spare parts kits whose instructions are indicated in the maintenance and trouble-shooting document."

TECHNICAL DATA		G10 1/2"	G10 3/4"	G26	G36	G46	G50T	G55R	G60R
Air Flow rate	m <sup>3</sup> /min - cfm	1 - 35,31	1,5 - 52,97	3,5 - 123,58	6 - 211,86	12 - 423,72	22 - 776,82	40 - 1412,4	60 - 2118,6
Pressure Drop	bar - psi	From 0,03 to 0,2 - From 0,435 to 2,9							
Materials		Housing in Aluminium alloy anodized. Internal parts in Stainless Steel, FPM/FKM sealings and Brass.							
Set opening pressure	bar - psi	From 3 to 5,5 bar. Standard settings : 4,5 ± 0,25 - From 43,5 to 79,8 psi. Standard settings : 65,25 ± 3,6							

THREADED VERSION		G10 1/2"	G10 3/4"	G26	G36	G46	G50T	Flanged version only	Flanged version only
X		G 1/2"	G 3/4"	G 1"	G 1-1/4"	G 1-1/2"	Rp 2"	-	-
Y	mm - inch	86 - 3,38	86 - 3,38	106 - 4,17	132 - 5,2	196 - 7,7	276 - 10,86	-	-
Z	mm - inch	32 - 1,26	32 - 1,26	50 - 1,97	61 - 2,4	59 - 2,32	67,5 - 2,65	-	-
L	mm - inch	Rp 1/2"	Rp 3/4"	Rp 1"	Rp 1 - 1/4"	Rp 1 - 1/2"	Rp 2"	-	-
K (hexagon)	mm - inch	36 - 1,41	36 - 1,41	45 - 1,77	55 - 2,16	70 - 2,75	86 - 3,38	-	-
W	mm - inch	33 - 1,3	33 - 1,3	38,5 - 1,51	47,5 - 1,87	70 - 2,75	70,5 - 2,77	-	-
Weight	kg - lb	0,3 - 0,66	0,3 - 0,66	0,6 - 1,32	1 - 2,2	1,8 - 3,96	3,2 - 7	-	-

FLANGED VERSION		Threaded version only	Threaded version only	G25F	G35F	G40F	G50	G55R	G60R
X	mm - inch	-	-	Ø30,5 - Ø1,2	Ø35 - Ø1,37	Ø50 - Ø1,96	Ø56,5 - Ø2,2	Ø80 - Ø3,15	Ø82 - Ø3,22
Y	mm - inch	-	-	95 - 3,74	113 - 4,44	200 - 7,87	276 - 10,86	281 - 11,06	328 - 12,9
Z	mm - inch	-	-	42 - 1,65	46,5 - 1,83	75 - 2,95	67,5 - 2,65	114,5 - 4,5	130 - 5,11
L	mm - inch	-	-	Rp 1"	Rp 1 - 1/4"	Ø40,3 - Ø1,58	Ø60 - Ø2,36	Ø80 - Ø3,15	Ø90 - Ø3,54
W	mm - inch	-	-	38 - 1,5	47 - 1,85	75 - 2,95	69,5 - 2,73	126 - 4,96	132 - 5,2
I (Inlet flange)	mm - inch	-	-	67 - 2,63	78 - 3,07	110 - 4,33	105 - 4,13	160 - 6,3	160 - 6,3
O (Outlet flange)	mm - inch	-	-	-	-	110 - 4,33	105 - 4,13	160 - 6,3	180 - 7
Flange Bores	mm	-	-	No. 2xØ11	No. 2xØ10,5	No. 4xØ17	No. 4xM12	No. 8xØ18	No. 8xØ18
	inch	-	-	N°2x 0,43	N°2x 0,41	N°4x 0,67	-	N°4x 0,71	N°4x 0,71
Weight	kg - lb	-	-	0,6 - 1,32	1 - 2,2	3,2 - 7,05	3,2 - 7,05	7,5 - 16,53	8 - 17,63

Attention: The drawing below is not suitable for all models. Please log on to our website for specific drawings.

## THREADED VERSION

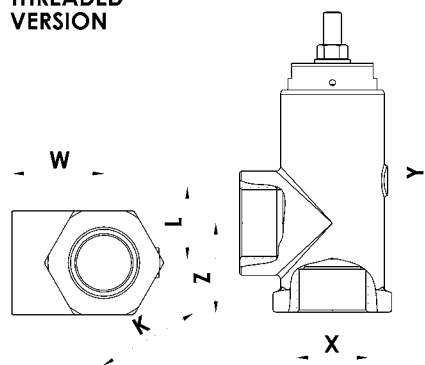

## FLANGED VERSION

